

SPADE TONGUE *Insulated*

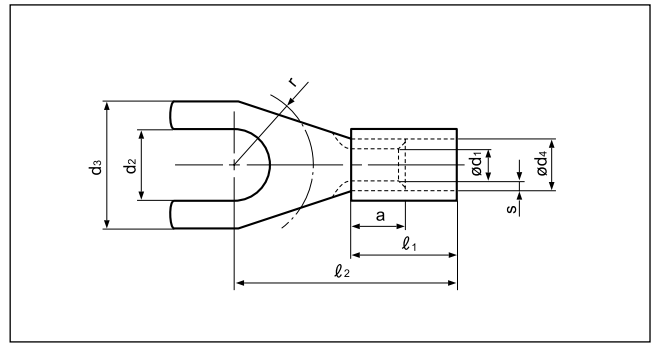

Vinyl-insulated

Applicable Wire mm ²	Stud Size Metric	Part No.	Nominal Size	Dimensions mm (in.)										Color	Tool No.	Qty/box
				ød ₂	ød ₃	r	l ₁	l ₂	a	ød ₁	ød ₄	s				
0.5 to 1	3.5	FVGS3.5-1C		3.7 (.146)	6.0 (.236)	4.5 (.177)	10.0 (.394)	16.0 (.630)	5.0 (.197)	1.6 (.063)	3.4 (.134)	0.8 (.031)	Red	WC-2210DIN	1,000	
	4	FVGS4-1C		4.3 (.169)	8.0 (.315)	6.0 (.236)		17.0 (.669)								
	4	FVGS4M-1C		4.3 (.169)	6.8 (.268)	5.5 (.217)		16.0 (.630)								
	5	FVGS5-1C		5.3 (.209)	10.0 (.394)	6.5 (.256)		18.0 (.709)								
>1 to 2.5	8	FVGS8-1C		8.4 (.331)	12.0 (.472)	10.0 (.394)	11.0 (.433)	22.0 (.866)	5.0 (.197)	2.3 (.091)	4.3 (.169)	0.8 (.031)	Blue	WC-2210DIN	1,000	
	3	FVGS3-2.5C		3.2 (.126)	6.0 (.236)	4.5 (.177)		17.0 (.669)								
	3.5	FVGS3.5L-2.5C		3.7 (.146)	6.8 (.268)	4.5 (.177)		17.0 (.669)								
	4	FVGS4S-2.5C		4.3 (.169)	6.8 (.268)	4.5 (.177)		17.0 (.669)								
	4	FVGS4-2.5C		4.3 (.169)	8.0 (.315)	6.0 (.236)		18.0 (.709)								
>2.5 to 6	5	FVGS5-2.5C		5.3 (.209)	10.0 (.394)	6.5 (.256)	12.0 (.472)	20.0 (.787)	6.0 (.236)	3.6 (.142)	6.4 (.252)	1.0 (.039)	Yellow	WC-2210DIN	500	
	4	FVGS4-6C		4.3 (.169)	8.0 (.315)	6.0 (.236)		20.0 (.787)								
	5	FVGS5-6C		5.3 (.209)	10.0 (.394)	6.5 (.256)		21.0 (.827)								
	8	FVGS8-6C		8.4 (.331)	14.0 (.551)	10.0 (.394)		25.0 (.984)								

Note: 1) Contact J.S.T.(U.K.) Ltd for the above tools.
 2) Delivery lead times may vary depending on the product. Contact JST for details.

Nylon-insulated

Applicable Wire mm ²	Stud Size Metric	Part No.	Nominal Size	Dimensions mm (in.)										Color	Tool No.	Qty/box
				ød ₂	ød ₃	r	l ₁	l ₂	a	ød ₁	ød ₄	s				
0.1 to 0.5	3	FNGS3-0.5C		3.2 (.126)	5.0 (.197)	5.0 (.197)	8.0 (.315)	14.0 (.551)	4.0 (.157)	1.0 (.039)	2.2 (.087)	0.5 (.020)	Yellow	—	2,000	
0.5 to 1	3.5	FNGS3.5-1C		3.7 (.146)	6.0 (.236)	4.5 (.177)	10.0 (.394)	16.0 (.630)	5.0 (.197)	1.6 (.063)	3.4 (.134)	0.8 (.031)	Red	WC-2210DIN	1,000	
	4	FNGS4-1C		4.3 (.169)	8.0 (.315)	6.0 (.236)		17.0 (.669)								
	4	FNGS4M-1C		4.3 (.169)	6.8 (.268)	5.5 (.217)		16.0 (.630)								
>1 to 2.5	5	FNGS5-1C		5.3 (.209)	10.0 (.394)	6.5 (.256)	11.0 (.433)	18.0 (.709)	5.0 (.197)	2.3 (.091)	4.3 (.169)	0.8 (.031)	Blue	WC-2210DIN	1,000	
	4	FNGS4-2.5C		4.3 (.169)	8.0 (.315)	6.0 (.236)		18.0 (.709)								
>2.5 to 6	5	FNGS5-2.5C		5.3 (.209)	10.0 (.394)	6.5 (.256)	12.0 (.472)	20.0 (.787)	6.0 (.236)	3.6 (.142)	6.4 (.252)	1.0 (.039)	Yellow	WC-2210DIN	500	
	4	FNGS4-6C		4.3 (.169)	8.0 (.315)	6.0 (.236)		21.0 (.827)								
	8	FNGS8-6C		8.4 (.331)	14.0 (.551)	10.0 (.394)		25.0 (.984)								

Note: 1) Contact J.S.T.(U.K.) Ltd for the above tools.
 2) Delivery lead times may vary depending on the product. Contact JST for details.